

Il presente disegno è di proprietà di Interpump Group S.P.A., ne è vietata la riproduzione o la divulgazione a termini di legge. This drawing belongs to Interpump Group S.P.A., copy or divulgation are forbidden by law.

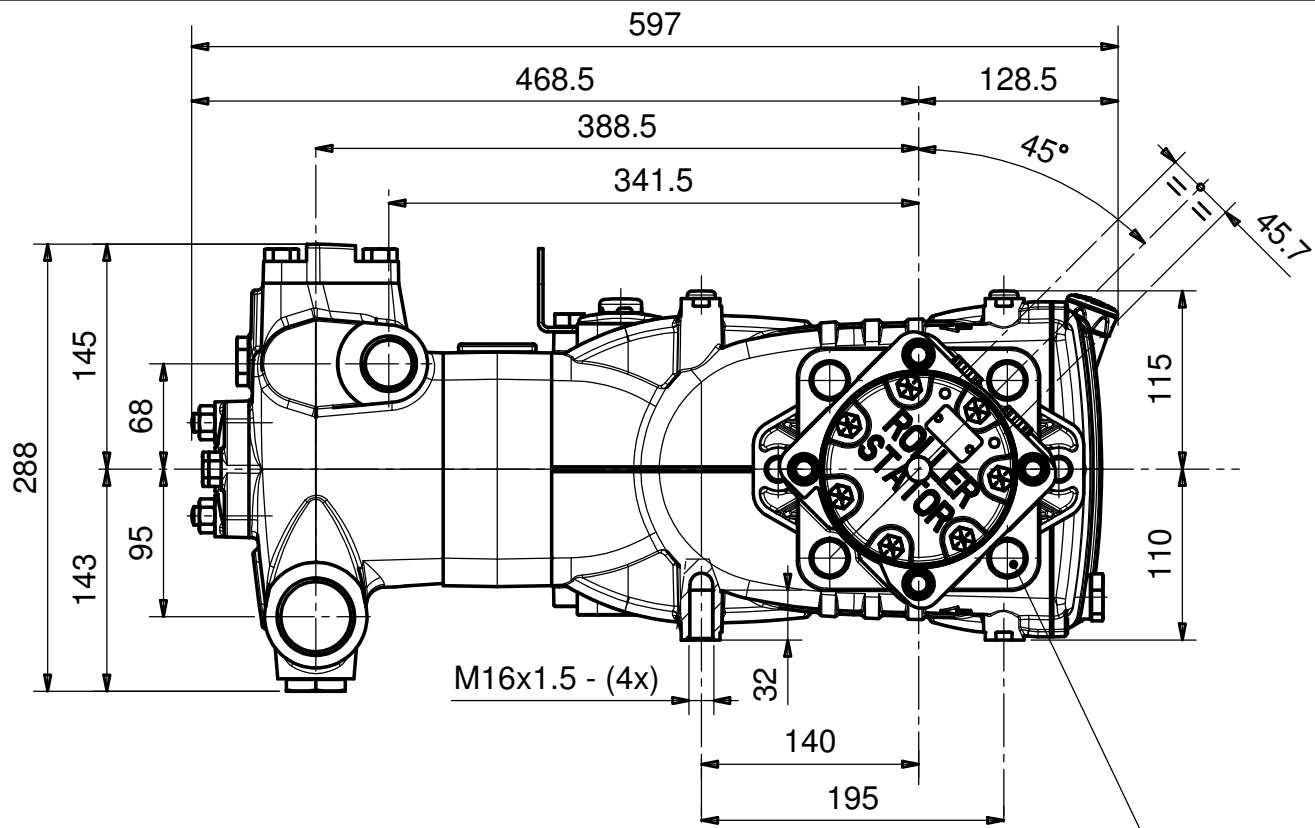

Per fissare il Motore Idraulico alla flangia utilizzare:
N.4 Rosette 14x24x2.5 cod.96728200
N.4 Viti T.E. M14x40 cod.99484800
serrate alla coppia di 130 Nm.

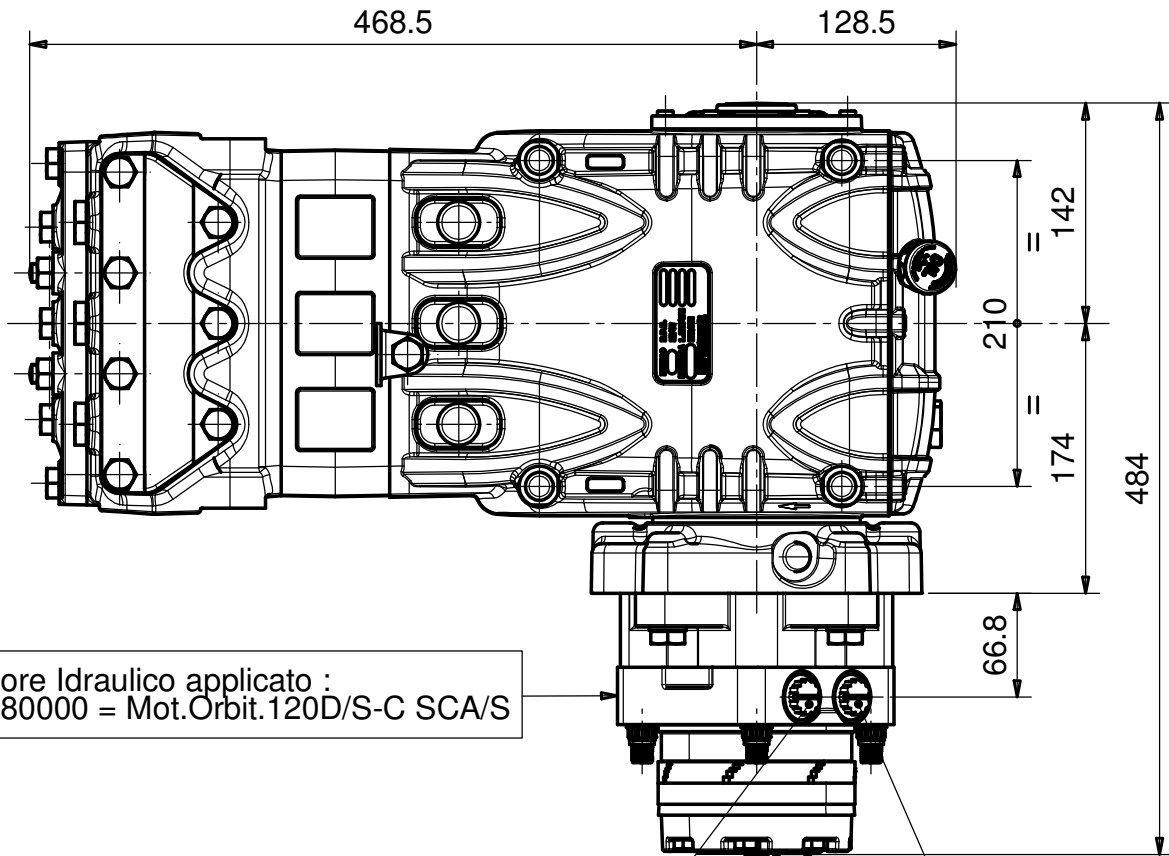



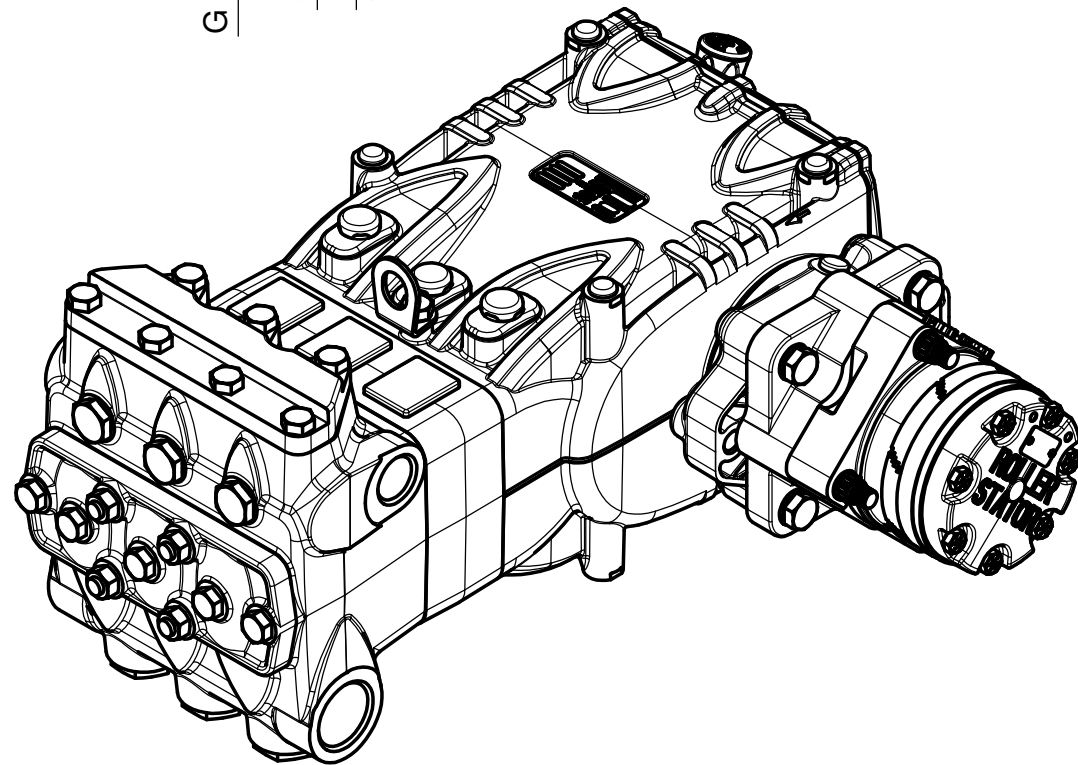
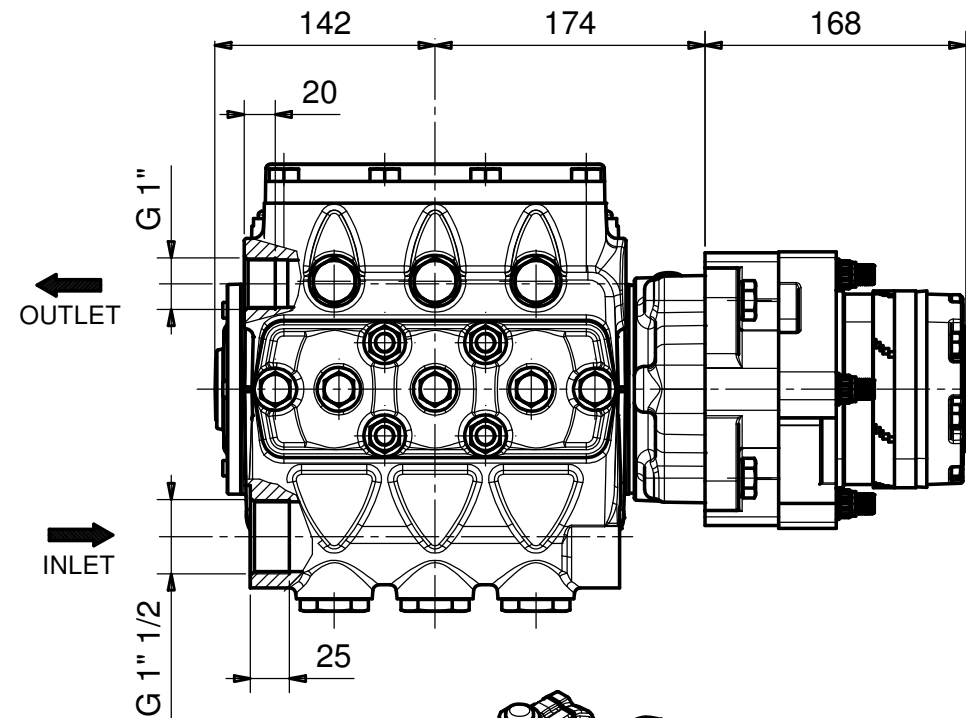

Motore Idraulico applicato :
95180000 = Mot.Orbit.120D/S-C SCA/S

Porta ingresso "P" = Pressione
Filettatura : 7/8" 14 THREAD

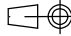
Porta uscita "T" = Scarico
Filettatura : 7/8" 14 THREAD



							
REV.	Data/Date	Descrizione modifica / Modification description			Firma/Signature	MT N°	
Peso Grezzo: Raw Weight:		0 g	Peso finito: Net weight:	0 g	Derivazione: Derivation:	Sostituisce: Replaces:	M.T.: 4190
MATERIALE: MATERIAL:							DISEGN.: Bertoli
STATO: RAW MAT.STATE:							FTECN.: Barbieri
TRATTAMENTI: TREATMENTS:							DATA: 15/03/2017
R:	N/mm²	Durezza: Hardness:	Colore: Colour:			SCALE: 1:5	
Foglio: 1 / 1							
DENOMINAZIONE / DENOMINATION						DIS. COD. / DRAWING CODE	REV.
INGOMBRO HY-PACK - KF5MHY120						71962700	0
LEGENDA CRITICITA': vedi DT n°2850000082 CRITICALITY LEGEND: according to DT n.2850000082		 Sicurezza Safety	 Critica Critical	 Importante Important	Nessun simbolo No symbol	Standard	CRITICITA': NONE